

Use & care manual

---

# **SHIATSU MASSAGE CUSHION WITH HEAT**

SL-256

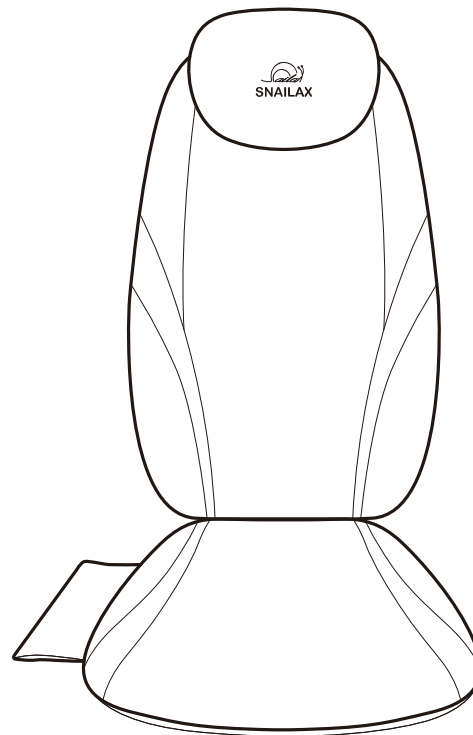

 **SNAILAX**

## Instruction

Congratulations on your purchase of the Snailax Massager. It combines lighted heat therapy together with 4 shiatsu massage nodes which rotate in unison to provide you with a deep-penetrating warmth and rejuvenating massage at home or away. Your body will feel more relaxed and rejuvenated.

## CONTENTS

---

- SL-256 Shiatsu massage cushion with Heat
- 12V home adapter
- 12V Car adapter



## TECHNICAL DATA

<b>Measurements:</b>	40 x 16 inches
<b>Weight:</b>	5.8lbs
<b>Voltage:</b>	Input: AC 100-240V ~50/60Hz Output: 12VDC 1500mA
<b>Nominal Power:</b>	max. 18 Watt
<b>Automatic runtime:</b>	15 minutes

**Please read all the safety instructions and warnings in manual before using this product.**

## Setup and Operation

1. Attach the massager to a chair with elastic straps or place it on other support.
2. Connect the adapter cable to the corresponding cable on the cushion.

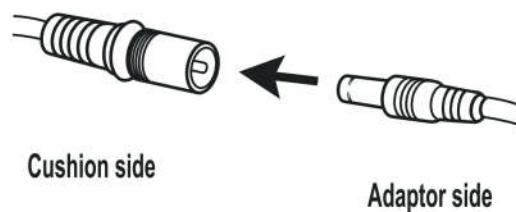

3. Plug the home adapter into an outlet or the car adapter into your car's power receptacle.
4. Turn on the device using the controller ( instructions on page 5 ).
5. When finished place the controller in the pouch at the side of the cushion.
6. You may soften the massage pressure by placing a towel between yourself and the device.



- Remove the adapter from the outlet when not in use.
- Do not setup or use the massager in a bathroom or similary wet / damp areas.
- Do not use this device while driving.
- For your own safety we equip the massager with a protection against over-heating. Heat is created in the motors when placed under great stress and excessive pressure. Before this could create any risk and after a runtime of 15 Minutes. The massager will switch off automatically and will only allow switching on again after an appropriate downtime.
- Likewise, you should allow your body some rest periods. To avoid straining your muscles too much, we recommend to not exceed a continuous massage of 15 Minutes.

## Safety Instructions



**Please read the following instructions carefully before putting your massage device into use to ensure trouble-free operation and optimum efficiency. Please retain these operating instructions for further use!**

- The massage device conforms to recognized technical principles and the latest safety regulations.
- Do not wet, do not use pins, never remove cover.
- This item is NOT A TOY. Close supervision is necessary when this appliance is used by, on, or near children or disabled persons.
- This appliance should never be left unattended when plugged in.
- Never use any power sources other than a standard 110V wall outlet or the 12V Car adaptor provided as original equipment with this unit.
- Any possible repairs may only be carried out by authorized expert staff. Improper use and unauthorized repairs are not permitted for safety reasons and lead to loss of warranty.
- Never touch the power plug with wet hands.
- Please avoid contact of the device with water, high temperatures and direct sunlight.
- Do not use any damaged cables, plugs or loose sockets.
- Never operate under blankets where the air opening may be blocked.
- If plugs or cords are damaged, they must be replaced by the manufacturer, a service representative or by qualified personnel.
- In case of malfunction, disconnect immediately from the mains.
- Do not use if you have skin disorders, open wounds, or swollen or inflamed areas.
- Misuse or incorrect use excludes any liability for damage.
- Do not use this device while driving.
- Do not use while you sleep.
- In order to avoid excessively stimulating the muscles and nerves, the recommended massage time should not be exceeded 15 minutes at a time.
- Each massage – even a hand massage – must be refrained from during pregnancy or if one or more of the following complaints are present in the massage area: recent injuries, thrombotic diseases, all kinds of inflammations and swellings, and cancer. It is recommended to consult a doctor before having a massage for the treatment of ailments and illnesses.
- If you are dependent on electrical aids e.g. pacemakers, please be sure to consult your doctor for medical advice before taking a massage.
- The packaging material supplied should not be used as a toy.

Failure to observe the above instructions may constitute misuse of the product and can cause serious injury or burns.

## Controller Instructions

NOTE: When ON/OFF button is pressed for first-time use, the massage mechanism will automatically move to the lowest position before starting a massage program. The massage mechanism will always return to this lowest position after the device has been turned off. If electrical supply is interrupted, the mechanism will revert to the lowest position when power is restored.

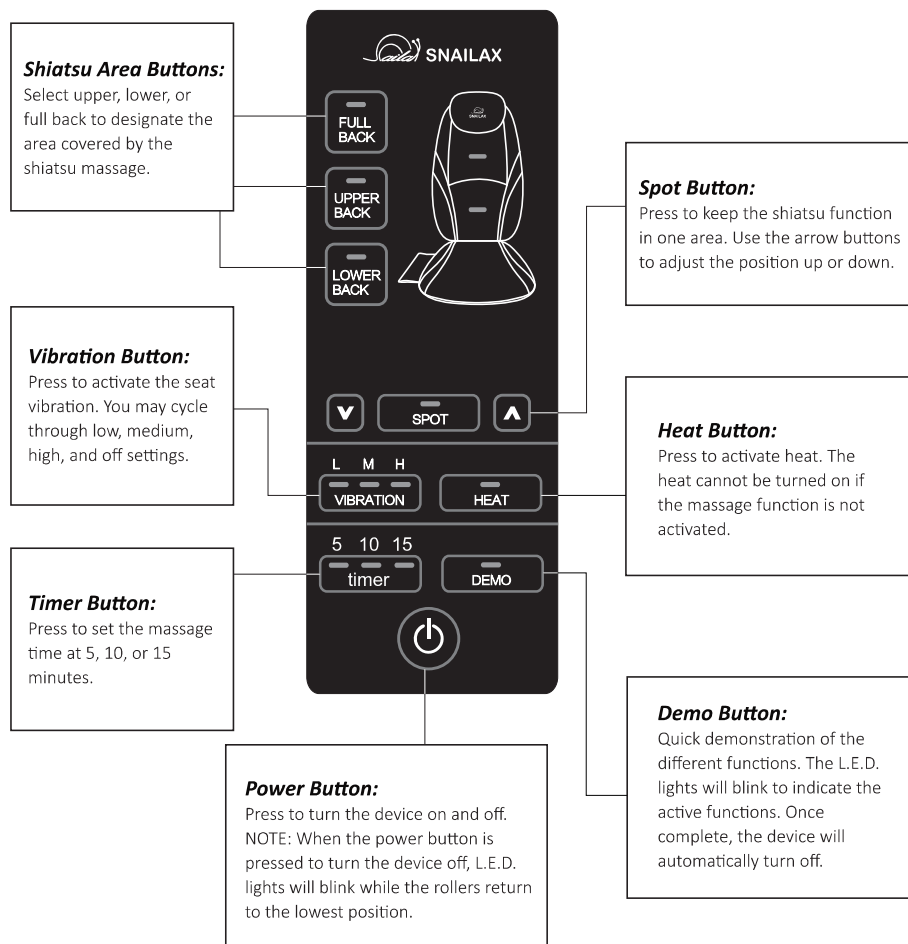

## Care and Cleaning Instructions

1. Do not wash in washing machine or immerse the product or the adapter in water.
2. Always switch off before cleaning and remove the adapter from the socket with clean, dry hands.
3. The massager should be wiped with a slightly moist cloth and dried thoroughly. Do not wipe the product with alcohol or harsh chemicals such as thinner or bleach.
4. Do not overstretch the eAlastic back straps.
5. Keep away from heat, fire or exposure to direct sunlight.
6. Do not apply excessive pressure or impact onto massager/massage heads. Application of a direct force in excess of 110 lbs. may damage your massager and invalidate your warranty. Refrain from over usage of the device.
7. Store the massager in a cool, dry place out of reach of children.
8. Avoid contact with sharp edges or pointed objects which might cut or puncture the cover of massager.

## TROUBLESHOOTING GUIDE

Fault	Solutions
Massage heads rotating at reduced speed.	The load on the massage heads is excessive. Reduce load and try again.
Massage heads only rotate in the upper or lower region.	The massage has been activated for the upper or lower back region. Press the 'Full Back' button for the massage to cover both regions.
Device switches off suddenly	Device may have been in use for 15mins. Auto-shut-off function activated. Continue using by pressing the 'power' button after resting the unit for 15mins.
	Over-heat protection function activated. Device is switched off for your safety. Please rest device for 15-30mins before restarting.
Device fail to start	Check if device has been used for more than 15mins. If so, let device rest for 15mins before continuing. Device may require longer time to cool in warmer environments.
	Check if adapter is plugged into socket.
	Check if adapter output is connected to device power inlet wire.
Jerky motion of massage heads / Vibrations from device	Excessive pressure may have been applied onto the device. Reduce the load and try again.
Infra-red lights are on but no motion from massage heads	Device may be jammed. Remove pressure / load from the device and press the 'Full Back' button to try again.

## Warranty

### **30-Day Money Back Guarantee for any reason**

Snailax product can be returned to receive a full refund for any reason within 30days. Please contact our customers service (support@snailax.com), our staff will contact you within 48 hours.

### **90-Day Money Back Guarantee for quality related issue**

Snailax product can be returned / replaced within 90 days if the product break down in the period of proper use.

### **24-Month Warranty for quality related issue**

If the product break down within 24 months in the period of proper use, customers can enjoy the relevant warranty to get them replaced.

### **Attention!**

No warranty will be given to any force majeure and man-made causes to a defective product, such as improper care, personal tear down and willful damage,etc.

### **Gratitude**

We are quite thankful for your trust in our Snailax brand. Snailax will continuously bring you a better user experience.

To learn more information about Snailax's healthy products, please visit:

[www.snailax.com](http://www.snailax.com)

[www.facebook.com/Snailax](https://www.facebook.com/Snailax)



1687 Plymouth Rd, Unit C,  
Ann Arbor, MI, 48105 U.S.A  
[support@snailax.com](mailto:support@snailax.com)  
[www.snailax.com](http://www.snailax.com)



1687 Plymouth Rd, Unit C,  
Ann Arbor, MI, 48105 U.S.A  
[support@snailax.com](mailto:support@snailax.com)  
[www.snailax.com](http://www.snailax.com)